





# Quick Install Guide

## Wireless N PowerLine Router



Thank you for purchasing the DHP-1320 Wireless N PowerLine Router. Follow the easy steps in this guide to properly set up your router. Please verify that all the package contents listed below are available.

### Package Contents

-  DHP-1320 Wireless N PowerLine Router.
-  Ethernet Cable
-  Two Detachable Antennas
-  Power Cord
-  CD-ROM with Manual and Setup Wizard

If any of the above items are missing, please contact your reseller.

### DHP-1320

### Before You Begin

- You can only use the Ethernet port on your modem. If you were using the USB connection before using the router, then you must turn off your modem, disconnect the USB cable and connect an Ethernet cable to the Internet port on the router, then turn the modem back on. In some cases, you may need to call your ISP to change connection types (USB to Ethernet).
- If you have DSL and are connecting via PPPoE, make sure you disable or uninstall any PPPoE software such as WinPoet, Broadjump, or Eternet 300 from your computer or you will not be able to connect to the Internet.
- When running the Setup Wizard from the D-Link CD, make sure the computer you are running the CD from is connected to the Internet and online or the wizard will not work. If you have disconnected any hardware, re-connect your computer back to the modem and make sure you are online.

### Router Placement

To get the best wireless coverage, place your router in an open area away from your computer, monitor, and speakers. Try to position the router so that the signal passes through drywall or open doorways. Materials and objects such as glass, steel, metal, walls with insulation, water (fish tanks), mirrors, file cabinets, brick, and concrete will degrade your wireless signal.

### LEDs

**Power LED**  
A solid light indicates a proper connection to the power supply.

**Internet LED**  
A solid light indicates connection on the Internet port. This LED blinks during data transmission.

**WLAN LED**  
A solid light indicates that the wireless segment is ready. This LED blinks during wireless data transmission.

**PowerLine AV LED**  
A solid light indicates that a PowerLine connection is established. The LED will blink quickly when data is transmitted to or from another PowerLine unit.

**LAN LEDs (1-3)**  
A solid light indicates a connection to an Ethernet-enabled computer on ports 1-3. This LED blinks during data transmission.

**USB LED**  
A solid light indicates connection on the USB port.

### Hardware Installation - For Router Mode

#### Start Here

Windows users can use the **Quick Router Setup Wizard** (from the CD) to configure their router. If you do not want to use the wizard, lost your CD, or are running Mac or Linux, you will need to use the manual setup procedure below.

#### Quick Router Setup Wizard

For the Wizard to work, the computer must be connected to the Internet and be online. If you have disconnected any hardware, please re-connect your computer back into the modem and make sure you are online.

**Insert the CD** into your drive on a computer that is online and click **Install Router** to start the Quick Router Setup Wizard. Follow the on-screen instructions to install and configure your router.

### Network Diagram

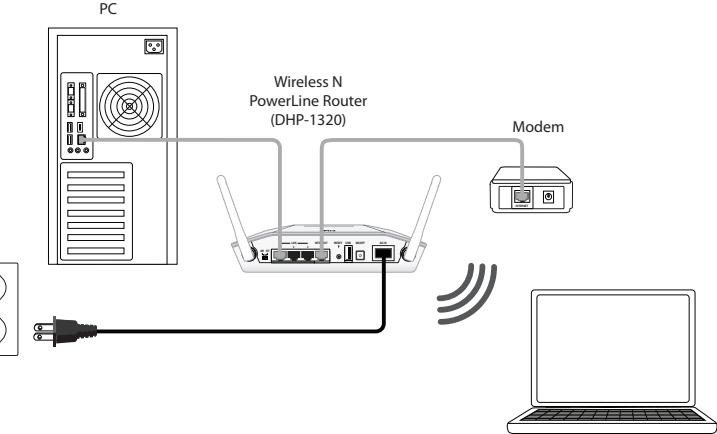

Figure 1

### Manual Setup

If you are using Mac or Linux or are unable to use the wizard from the CD, use the manual setup outlined below or refer to the user manual on the CD for more information.

**Step 1**  
Turn off the DSL or cable modem by unplugging it and position your router close to your modem. Unplug the Ethernet cable from the modem that is connected to your computer. Then, plug it into the blue port labeled 1 on the back of your router. The router is now connected to your computer.

**Step 2**  
Plug one end of the included Ethernet cable that came with your router into the yellow port labeled **INTERNET** on the back of the router. Plug the other end of this cable into the Ethernet port on your modem. Turn on the modem by plugging it and let it boot. Let it complete its connection to your ISP before proceeding to the next step.

**Step 3**  
Connect the supplied power cord into the power receptor located on the back of the router and then plug into a wall outlet (Please do not use a power strip or a surge protector). Turn on the DHP-1320 Router by pushing the power button located on the back of this unit.

**Note:** Power source is confirmed when the green LED Power Indicator on the Wireless N PowerLine Router is illuminated.

**Step 4**  
Open a web browser, enter **http://192.168.0.1** (or **http://dlinkrouter**) and then press **Enter**. When the login window appears, set the user name to **Admin** and leave the password box blank. Click **Log In** to continue the Internet Connection setup wizard. This wizard will walk you through a step-by-step process to configure DHP-1320 and connect to the Internet. To run the Wireless Connection Setup Wizard, click the **Wireless Connection Setup Wizard** button in the **Setup>Wireless Settings** windows.

### PowerLine Network Devices Setup

**Note:** A minimum of two PowerLine AV devices are required to create a network in order for your product to work properly.

**Note:** To verify connectivity or if you are having connection problems, plug the powerline devices in the same room to verify whether your home's electrical wiring is connecting to the network and working properly. The PowerLine LED indicators will illuminate if the connection is established.

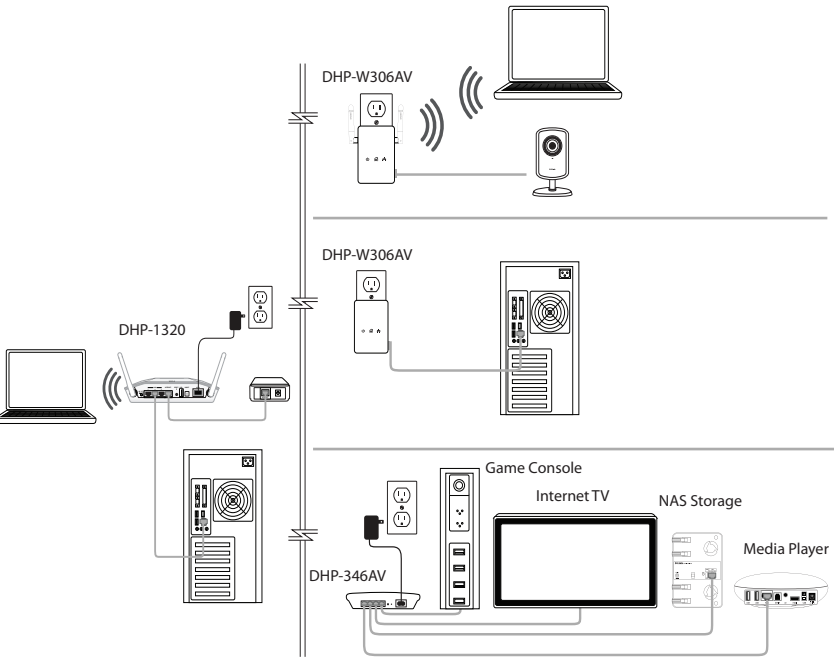

Figure 2

#### Step 1

Plug the other PowerLine AV devices in the same room to verify if your home's electrical wiring is suitable for the PowerLine Network. Once configured you may place your PowerLine AV devices in the location of your choice.

#### Step 2

Press the **Simple Connect** button located on the side of the DHP-1320 for 2 seconds. The Power LED will start blinking after you release the button. Within 2 minutes of pushing the **Simple Connect** button on the DHP-1320, press the **Simple Connect** button on the second PowerLine AV device(s) in your existing PowerLine network for 2 seconds. The Power LED will start blinking after you release the button. Network Connectivity is confirmed when the PowerLine AV LEDs indicators on the DHP-1320 and PowerLine AV device are illuminated.

#### Step 3

If your network has more than two PowerLine AV devices, press the **Simple Connect Button** on the DHP-1320 for 2 seconds. Within 2 minutes of pushing the **Simple Connect Button** on the DHP-1320, press the **Simple Connect Button** on any additional PowerLine AV devices in your existing PowerLine network for 2 seconds. Network Connectivity is confirmed when the PowerLine AV LEDs indicators on the DHP-1320 and PowerLine AV device are illuminated.

#### Step 4

After the network security setup steps, your PowerLine network will be securely configured with the same network encryption key. Place any additional PowerLine AV devices in a different area of your home. The PowerLine AV devices will save the security settings even if they are unplugged.

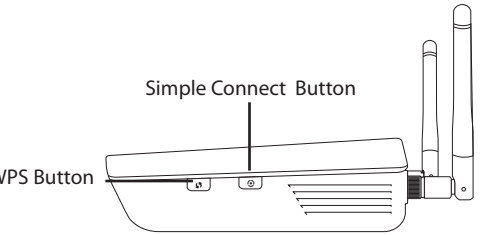

### Hardware Installation - For Access Point Mode

#### Network Diagram

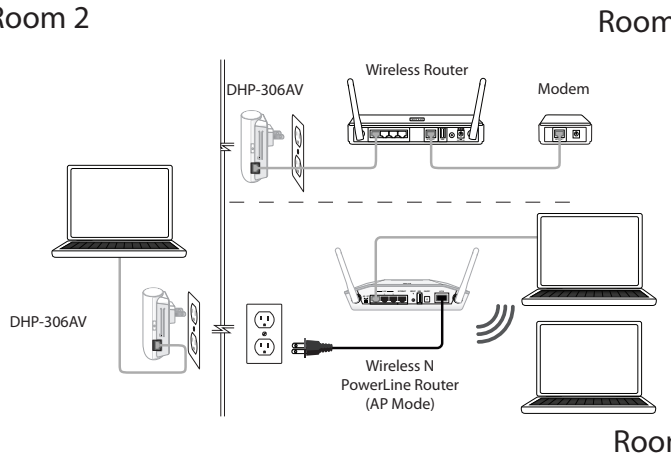

Figure 3

#### Step 1

Plug the DHP-1320 in the same room as your existing PowerLine Network in order to verify whether your home's electrical wiring is suitable for the Powerline Network. Once configured you may place your DHP-1320 to the location of your choice.

#### Step 2

Move the switch on the back of the DHP-1320 to **"AP"**. Connect the supplied power cord into the power receptor located on the back of the DHP-1320 and plug into a wall outlet (Please do not plug to power strip or surge protector). Turn on the DHP-1320 by pushing the power button located on the back of this unit. Connect one end of the included Ethernet cable to the blue port labeled LAN 1 on the back of DHP-1320 and attach the other end of the Ethernet cable to the PC.

**Note:** Power source is confirmed when the green LED Power Indicator on the DHP-1320 is illuminated. Network Connectivity is confirmed when the PowerLine AV LEDs indicators on the DHP-1320 and PowerLine AV device are illuminated.

#### Step 3

If you applied security on your other PowerLine devices and you have plugged in your new D-Link Wireless N PowerLine Router, press the **Simple Connect** button on the DHP-1320 for 2 seconds. The Power LED will start blinking after you release the button. Within 2 minutes of pushing the **Simple Connect** button on the DHP-1320, press the **Simple Connect** button on the additional PowerLine AV device(s) in your existing PowerLine network for 2 seconds. The Power LED will start blinking after you release the button. Network Connectivity is confirmed when the PowerLine AV LEDs indicators on the DHP-1320 and PowerLine AV device are illuminated.

#### Step 4

After the network security setup steps, your PowerLine network will be securely configured with the same network encryption key. Place DHP-1320 in a different area in your home. The DHP-1320 will retain the security settings even if they are unplugged.

#### Step 5

Open a web browser, enter **http://dlinkrouterWXYZ** (WXYZ: four-digit suffix of the PLC MAC Address) and then press **Enter**. When the login window appears, Set the user name to **Admin** and leave the password box blank. Click **Log In** to continue the setup. To run the Wireless Connection Setup Wizard, click the **Wireless Connection Setup Wizard** button in the Setup -> **Wireless Settings** window. This wizard will walk you through a step-by-step process to configure your wireless setting.

### Technical Support

Having trouble installing your new product? D-Link's website contains the latest user documentation and software updates for D-Link products. U.S. and Canadian customers can contact D-Link Technical Support through our website or by phone.

#### United States

Telephone: (877) 453-5465  
Internet: <http://support.dlink.com>

#### Canada

Telephone: (800) 361-5265  
Internet: <http://support.dlink.ca>

Copyright ©2011 D-Link Corporation/D-Link Systems, Inc. All rights reserved. D-Link and the D-Link logo are registered trademarks of D-Link Corporation or its subsidiaries in the United States and other countries. Other trademarks are the property of their respective owners. Maximum wireless signal rate derived from IEEE Standard 802.11g and 802.11n specifications. Actual data throughput will vary. Network conditions and environmental factors, including volume of network traffic, building materials and construction, and network overhead, lower actual data throughput rate. Environmental factors will adversely affect wireless signal range. Product specifications, size and shape are subject to change without notice, and actual product appearance may differ from that depicted on the packaging. Visit [www.dlink.com](http://www.dlink.com) for more details.